



SOLITRONICS ENGINEERING LTD.

TEL: (852) 2730-8145

FAX: (852) 2730-3245

E-mail: info@solitronics.com

T-10x25mm BA9S Neon Signal Lamps with Polycarbonate Fresnel-Ring Lens-cap

Date:

18th July 2005

T-10x25mm BA9s with Internal Resistor For 110/130V, 220/240V & 380/400V

Data Sheet:

SEL-NPC-1025-X2

1. PHYSICAL SIZE

Diameter: 10.0mm + 0 / -1.0mm

Length: 25.0mm + 0 / -1.5mm

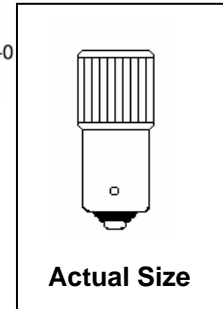
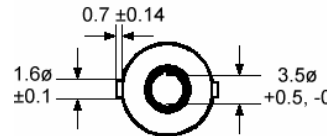
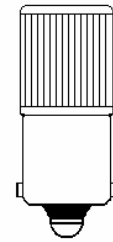
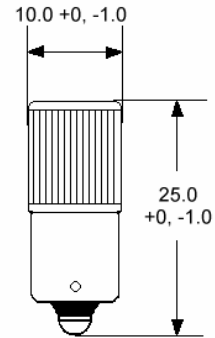

Actual Size

2. BASE

Miniature Bayonet
Din 49712 BA9S

3. LAMP TYPE

Neon	For clear, amber, yellow and red lens
Green-Fluorescent	For clear and green translucent lens
Blue-Fluorescent	For clear and blue translucent lens

4. ELECTRICAL RATING

SEL P/N	Equivalent Schneider P/N	Lamp Type	Voltage	Current ± 0.5mA	Design Life Expectancy
1025-12-N	DL1CF110AA	Neon	110/130V	2.0mA	10,000 hrs.
1025-12-G		Green	110/130V	2.0mA	10,000 hrs.
1025-12-B		Blue	110/130V	2.0mA	5,000 hrs.
1025-22-N		Neon	220/240V	2.0mA	10,000 hrs.
1025-22-G		Green	220/240V	2.0mA	10,000 hrs.
1025-22-B		Blue	220/240V	2.0mA	5,000 hrs.
1025-32-N		Neon	380/400V	1.5mA	10,000 hrs.
1025-32-G		Green	380/400V	1.5mA	10,000 hrs.
1025-32-B		Blue	380/400V	1.5mA	5,000 hrs.

5. APPLICATIONS

For use in 22ømm Lighted Push-button switches & Pilot-lights (ABB, Allen-Bradley, Baco, Benedikt & Jager, Breter, EAO, Fuji-Electric, GE Power-Controls, IDEC-Izumi, Klockner-Moeller, Kraus & Naimer, Legrand, Lovato, Omron, Rafi, Schneider-Telemecanique, Simens, Sprecher+Schuh etc.etc.) Available for use with Pilot Lights with Red, Green, Amber or Blue Lens-cap.

6. REMARKS :-

Also widely used as replacement lamps for indicators and lighted push-button switches of Japanese lifts (Fuji, Hitachi, Mitsubishi, etc.)